

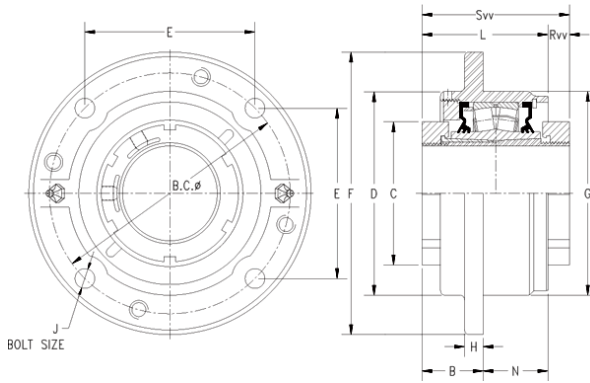

SAF BEARING LIMITED



timken QVVCW12V055S Solid Block/Spherical Roller Bearing Housed Units- Double V-Lock Piloted Flange Cartridge

Bearing No. QVVCW12V055S

QVVCW12V055S Bearing 2D drawings and 3D CAD models

Engineering Group	Mounted Bearing
Shaft Size	55 mm
Shaft Size Type	Metric
Full Timken Part Number	QVVCW12V055SB
Locking Style	Double V-Lock
Weight	13 lb
Housing Style	Piloted Flange Cartridge
UPC Code	0883450091374
Dimension BC	6.00 in
Dimension C	3.160 in
Dimension E	4.24 in
Dimension B Fix	1.70 in
Dimension B Exp	1.79 in
Dimension F	7.13 in
Dimension D	5.00 in
Dimension H	0.56 in
Dimension J (Bolt Size)	0.5 in
Dimension L	3.33 in
Dimension RVV	0.69 in
Dimension SVV	4.02 in
Dimension G	5.000 in
Dimension N	1.63 in
C - Dynamic Load (Basic)	38100 lb
C0 - Static Load	39000 lb
e - Geometry Factor	0.24



SAF BEARING LIMITED

Y1 - Geometry Factor	2.84
Y2 - Geometry Factor	4.23
Oil Lubrication - M/N Seal	2000 rpm
Oil Lubrication - T Seal	3500 rpm
Oil Lubrication - B/C/O Seal	1650 rpm
Grease Lubrication - M/N Seal	2000 rpm
Grease Lubrication - T Seal	3000 rpm
Grease Lubrication - B/C/O Seal	1550 rpm
Float	0.050 in
Shaft Tolerance	0.0015 in
Eng Internal Radial Clearance - Min	0.0030
Eng Internal Radial Clearance - Max	0.0037
Pre Install Clearance Min	0.0030 in
Pre Install Clearance Max	0.0037 in