

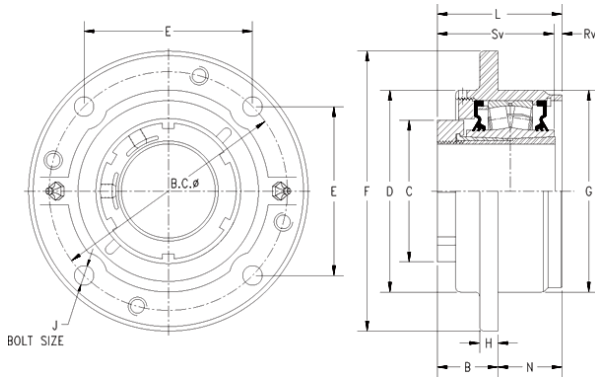

# SAF BEARING LIMITED



## timken QVCW28V500S Solid Block/Spherical Roller Bearing Housed Units-Single V-Lock Piloted Flange Cartridge

Bearing No. QVCW28V500S

QVCW28V500S Bearing 2D drawings and 3D CAD models

| Engineering Group        | Mounted Bearing          |
|--------------------------|--------------------------|
| Shaft Size               | 5 in                     |
| Shaft Size Type          | Imperial                 |
| Full Timken Part Number  | QVCW28V500SB             |
| Locking Style            | Single V-Lock            |
| Weight                   | 102 lb                   |
| Housing Style            | Piloted Flange Cartridge |
| UPC Code                 | 0883450091145            |
| Dimension BC             | 12.75 in                 |
| Dimension C              | 7.480 in                 |
| Dimension E              | 6.38 in                  |
| Dimension B Fix          | 2.62 in                  |
| Dimension B Exp          | 2.70 in                  |
| Dimension F              | 14.75 in                 |
| Dimension H              | 1.03 in                  |
| Dimension J (Bolt Size)  | 0.875 in                 |
| Dimension L              | 5.69 in                  |
| Dimension RV             | 0.13 in                  |
| Dimension SV             | 5.82 in                  |
| Dimension G              | 11.000 in                |
| Dimension N              | 3.07 in                  |
| C0 - Static Load         | 237000 lb                |
| C - Dynamic Load (Basic) | 194000 lb                |
| e - Geometry Factor      | 0.25                     |
| Y1 - Geometry Factor     | 2.67                     |



## SAF BEARING LIMITED

|                                     |           |
|-------------------------------------|-----------|
| Y2 - Geometry Factor                | 3.98      |
| Oil Lubrication - M/N Seal          | 650 rpm   |
| Oil Lubrication - T Seal            | 1200 rpm  |
| Oil Lubrication - B/C/O Seal        | 350 rpm   |
| Grease Lubrication - M/N Seal       | 650 rpm   |
| Grease Lubrication - T Seal         | 900 rpm   |
| Grease Lubrication - B/C/O Seal     | 350 rpm   |
| Float                               | 0.083 in  |
| Shaft Tolerance                     | 0.0050 in |
| Eng Internal Radial Clearance - Min | 0.0063    |
| Eng Internal Radial Clearance - Max | 0.0079    |
| Pre Install Clearance Min           | 0.0063 in |
| Pre Install Clearance Max           | 0.0079 in |